



7200 FORGED SERIES

3,250 LBS



FEATURES

KINGPIN: 1" diameter integral kingpin and nut
RACEWAY: 1/2" diameter upper ball race with tapered roller thrust bearing
BUSHING: Roller bearings with drilled hardened steel spanner bushing and steel side washers
AXLE&NUT: 3/4" axle and lock nut

FINISH: Corrosion resistant bright zinc
LUBRICATION: Grease nipple in lower race
HARDENED: Drop forged hardened rolled in raceway
LEG SPACING: 3"
SPECIAL: Robotic welded. AISI 1045 drop forged steel top plate

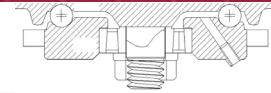

EXCELLENT FOR:

- Industrial platforms
- Garbage & cargo containers
- Dolly carts
- Heavy loads
- Factory use
- Heavy material handling
- Abusive applications



OPTIONS:

- TSB Thumb Screw Brake
- UWB Universal Wheel Brake
- BR Bronze Bearing
- DB Delrin Bearing
- PB Precision Ball Bearing
- SWH Heat-treated Side Washer
- TG Thread Guards
- Z Zerk in Axle

WHEEL		CASTER				PART NUMBER				
Diameter	Tread Width	Capacity Lbs.	Bearing Type	Swivel Radius	Overall Height	Wheel Type	Swivel	Caster Weight (lbs)	Rigid	Caster Weight (lbs)
6"	2 1/2"	700	Roller	5 9/32"	8"	Moldon Rubber	S7206-A53J-MR-RB	19.29	R7206-A53J-MR-RB	14.41
		1,200	Roller			Envirothane™	S7206-A53J-U-RB	16.09	R7206-A53J-U-RB	11.21
		1,200	Precision			Envirothane™ Grey - PB	S7206-A53J-UG-PB	15.93	R7206-A53J-UG-PB	11.05
		1,200	Roller			Envirothane™ Grey - RB	S7206-A53J-UG-RB	16.09	R7206-A53J-UG-RB	11.21
		1,300	Roller			ALTHane™	S7206-A53J-ALT-RB	15.29	R7206-A53J-ALT-RB	10.41
		1,600	Roller			Phenolic	S7206-A53J-PH-RB	16.99	R7206-A53J-PH-RB	12.11
		1,600	Roller			Moldon Urethane	S7206-A53J-UR-RB	20.01	R7206-A53J-UR-RB	15.13
		1,800	Roller			Solid Steel	S7206-A53J-SS-RB	23.21	R7206-A53J-SS-RB	18.33
		2,500	Roller			V Groove	S7206-A53J-VG-RB	21.69	R7206-A53J-VG-RB	16.81
		8"	2 1/2"			850	Roller	6 1/8"	10 1/2"	Moldon Rubber
1,400	Roller			ALTHane™	S7208-A53J-ALT-RB	16.00	R7208-A53J-ALT-RB			12.73
1,600	Roller			Envirothane™	S7208-A53J-U-RB	17.45	R7208-A53J-U-RB			14.19
1,600	Precision			Envirothane™ Grey - PB	S7208-A53J-UG-PB	17.14	R7208-A53J-UG-PB			13.88
1,600	Roller			Envirothane™ Grey - RB	S7208-A53J-UG-RB	17.45	R7208-A53J-UG-RB			14.19
1,800	Roller			Solid Steel	S7208-A53J-SS-RB	27.95	R7208-A53J-SS-RB			24.69
2,000	Roller			Phenolic	S7208-A53J-PH-RB	18.36	R7208-A53J-PH-RB			15.10
2,000	Roller			Moldon Urethane	S7208-A53J-UR-RB	24.31	R7208-A53J-UR-RB			21.05
2,500	Roller			V Groove	S7208-A53J-VG-RB	26.59	R7208-A53J-VG-RB			23.33
10"	2 1/2"			1,000	Roller	7 9/16"	12 1/2"			Moldon Rubber
		2,000	Roller	Solid Steel	S7210-A53J-SS-RB			29.09	R7210-A53J-SS-RB	25.93
		2,100	Roller	Lava™-WOW (475)	S7210-A53J-LVW-RB			18.13	R7210-A53J-LVW-RB	14.97
		2,200	Roller	Moldon Urethane	S7210-A53J-UR-RB			27.57	R7210-A53J-UR-RB	24.41
		2,500	Roller	Phenolic	S7210-A53J-PH-RB			20.35	R7210-A53J-PH-RB	17.19
		3,250	Roller	RollX™-WOW	S7210-A53J-RXW-RB			18.13	R7210-A53J-RXW-RB	14.97
		3,250	Roller	Solid Steel	S7210-A53J-SSR-RB			29.05	R7210-A53J-SSR-RB	25.89
12"	2 1/2"	1,200	Roller	9"	14 1/16"	Moldon Rubber	S7212-A53J-MR-RB	31.01	R7212-A53J-MR-RB	26.03
		2,000	Roller			Solid Steel	S7212-A53J-SS-RB	34.59	R7212-A53J-SS-RB	29.61
		2,500	Roller			Moldon Urethane	S7212-A53J-UR-RB	34.97	R7212-A53J-UR-RB	30.00
		3,000	Roller			Phenolic	S7212-A53J-PH-RB	26.53	R7212-A53J-PH-RB	21.55

PLATE DIAGRAMS

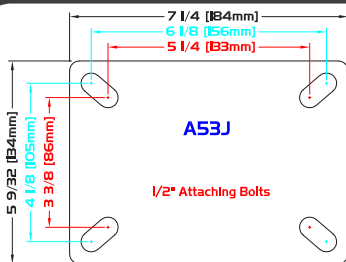

STANDARD PLATE: A53J

Plate Thickness: 3/8"